

## Pole Mount Kit, SC-2MMA9 Series Small Cell Cabinets



### SC-POLE-KIT

## Pole Mount Kit, SC-2MMA9 Series Small Cell Cabinets

### Features

- Pole Mount Kit for SC-2MMA9 Series Small Cell Cabinets
- Supports Mounting to External Pole Structures 2" to 10" Diameter

### Applications

- Small Cells
- Pico Cells
- Micro Cells
- Macro Cells
- 5G Nodes
- DAS Systems
- Load Expansion

### Mechanical Specifications

Weight 1 lbs [453.59 g]

### Environmental Specifications

Temperature (Operating Range) -20 to +65 deg C

Transtector Systems specializes in protection of highly sensitive, low voltage equipment through its patented, non-degrading silicon diode technology and custom filters. Our power quality expertise translates into a diverse product offering including AC, DC, and signal applications as well as integrated cabinets, power distribution panels and EMP hardened devices.

Click the following link (or enter part number in "SEARCH" on website) to obtain additional part information including price, inventory and certifications: [Pole Mount Kit, SC-2MMA9 Series Small Cell Cabinets SC-POLE-KIT](#)

URL: <https://www.transtector.com/pole-mounting-kit-sc-pole-kit-p.aspx>

The information contained in this document is accurate to the best of our knowledge and representative of the part described herein. It may be necessary to make modifications to the part and/or the documentation of the part, in order to implement improvements. Transtector reserves the right to make such changes as required. Unless otherwise stated, all specifications are nominal. Transtector does not make any representation or warranty regarding the suitability of the part described herein for any particular purpose, and Transtector does not assume any liability arising out of the use of any part or documentation.

SC-POLE-KIT CAD Drawing

REVISIONS			
REV.	DESCRIPTION	DATE	APPROVED
A	INITIAL RELEASE	8/29/19	DWR

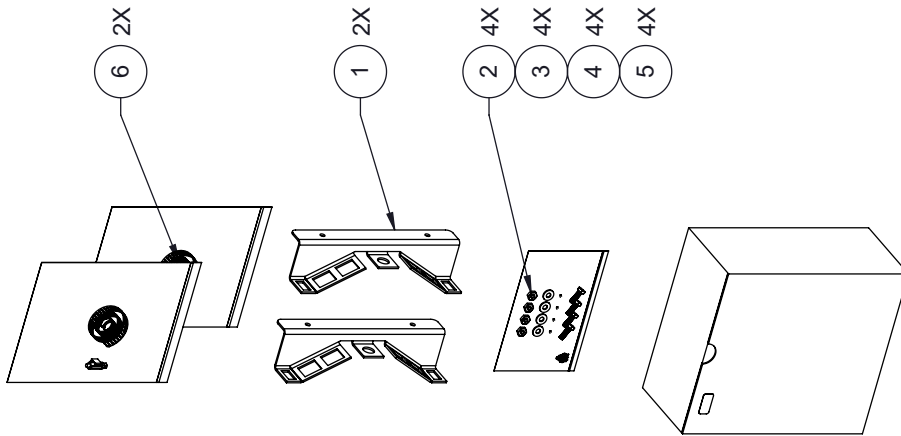

KIT CONTENTS

ITEM	QTY.	DESCRIPTION
1	2	BRACKET "V" POLE MOUNT CHATEAU
2	4	NUT 10-32 HEX 18-8 SS
3	4	WASHER FLAT #10 ZINC
4	4	WASHER LOCK #10 SPLIT 18-8 SS
5	4	SCREW, 10-32 X 5/8" HEX ZN
6	2	CLAMP HOSE 10"

UNLESS OTHERWISE SPECIFIED LEADING DIMENSIONS ARE INCHES DIMENSIONS IN [ ] ARE MILLIMETERS

TOLERANCES:  
 .X±.2 [5,08]  
 XX±.01 [.25]  
 XXX±.005 [.13]

FRACTIONS ± 1/32  
 ANGLES ± 1°

ALL DIMENSIONS SHOWN ARE FOR REFERENCE ONLY.  
 THIRD-ANGLE PROJECTION

**TRANSTECTOR**  
 an INFINIT brand

10701 Airport Road, Hayden, ID 83835  
 Phone: 1.208.635.6400 | 1.800.882.9110  
 Fax: 1.208.955.2041  
 www.transtector.com | e-mail: sales@transtector.com

SIZE: A  
 CAGE: 30992  
 DRAWN BY: HMB  
 PART NUMBER: SC-POLE-KIT

THE INFORMATION AND DESIGN IN THIS DOCUMENT IS THE PROPERTY OF TRANSTECTOR, INC. ALL RIGHTS RESERVED.

SHEET 1 OF 1  
 SCALE 1:8  
 REV A

THESE COMMODITIES, TECHNOLOGY OR SOFTWARE WERE EXPORTED FROM THE UNITED STATES IN ACCORDANCE WITH THE EXPORT ADMINISTRATION REGULATIONS. DIVERSION CONTRARY TO U.S. LAW PROHIBITED.

T-Rev.C