

THE INFORMATION CONTAINED IN THIS DRAWING IS THE SOLE PROPERTY OF TRANSTECTOR, INC.. ANY REPRODUCTION IN PART OR WHOLE WITHOUT THE WRITTEN PERMISSION OF TRANSTECTOR, INC. IS PROHIBITED.

REVISIONS			
REV	DESCRIPTION	DATE	APPROVED
A	INITIAL RELEASE	11/06/2019	MMARTINEZ

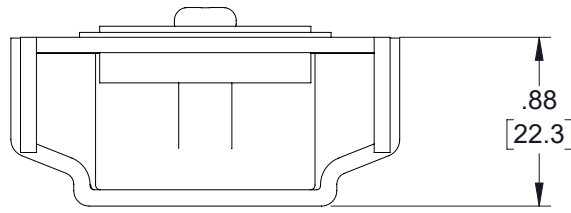
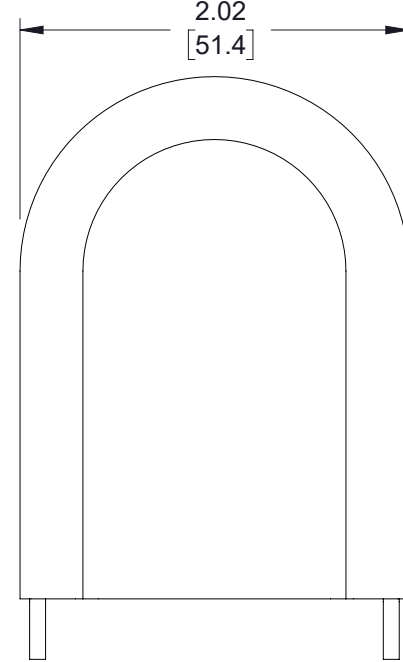
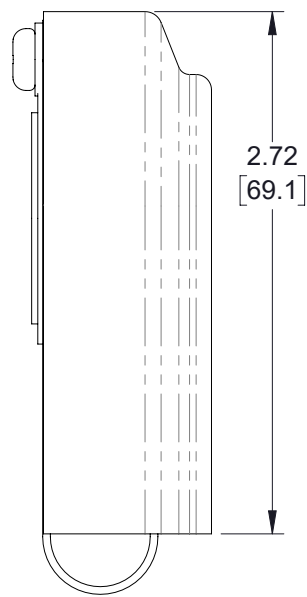
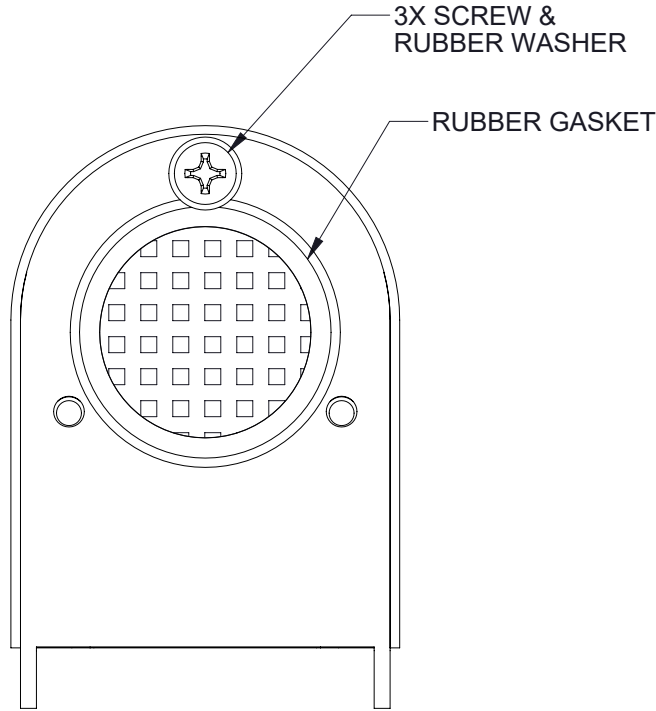

**SHROUD MATERIAL:
POLYPROPYLENE**

UNLESS OTHERWISE SPECIFIED,
DIMENSIONS ARE IN INCHES [mm]

OVERALL CABLE LENGTH TOLERANCE:
 ≤12 [305] = +1 [25] / -0
 >12 [305] ≤60 [1524] = +2 [51] / -0
 >60 [1524] ≤120 [3048] = +4 [102] / -0
 >120 [3048] ≤300 [7620] = +6 [152] / -0
 >300 [7620] = +5% / -0

ALL OTHER DIMENSIONAL TOLERANCES:
 .X = ± .2 [5] FRACTIONS ± 1/32
 .XX = ± .02 [5] ANGLES ± 1°
 .XXX = ± .005 [1.3]

THIRD-ANGLE PROJECTION

APPROVALS	DATE
DRAWN BY DZINN	11/06/2019
CHECKED BY DFRISIELLO	11/06/2019
APPROVED BY MMARTINEZ	11/06/2019

TRANSTECTOR
an INFINIT@ brand

10701 Airport Road,
Hayden, ID 83835
Phone: 1.208.635.6400
Fax: 1.208.955.2041

CATEGORY	ENCLOSURE		
PRODUCT DESCRIPTION	Outdoor Vent - Labyrinth non metallic vent		
SIZE	CAGE CODE	DWG. NO.	REV.
A	30992	TEPC-V3	A
SCALE: NONE		CAD FILE: TEPC-V3.SLDDRW	SHEET 1 OF 1